

# Wireless Onboard

Configuration Manual

iPad Device



# Wireless Onboard – iPad Device

1. Click connect on WiFi name USIM-ONBOARD

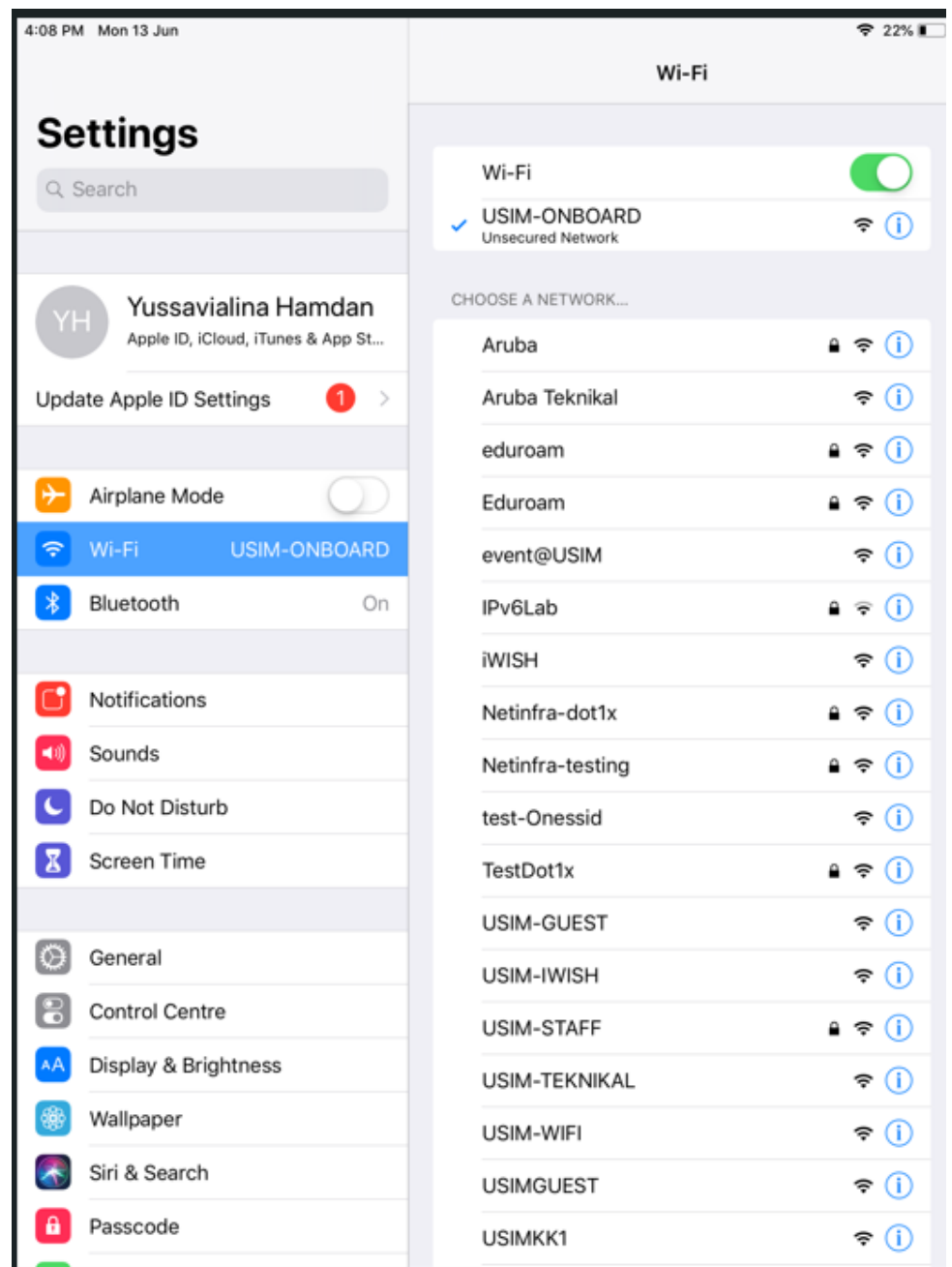

2. Browse to any website such as “cppm” click any website

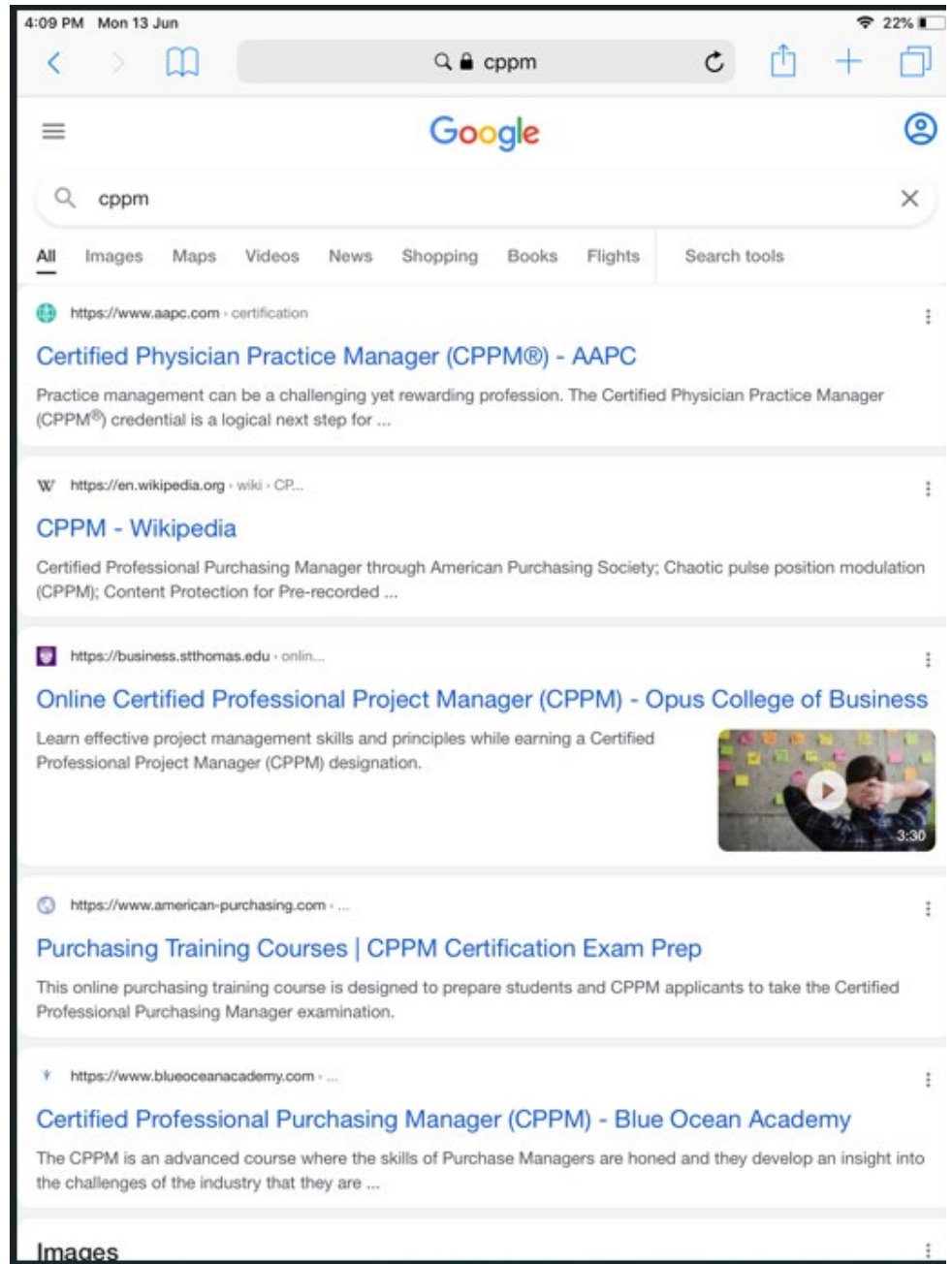

3. Click button Show Details to proceed

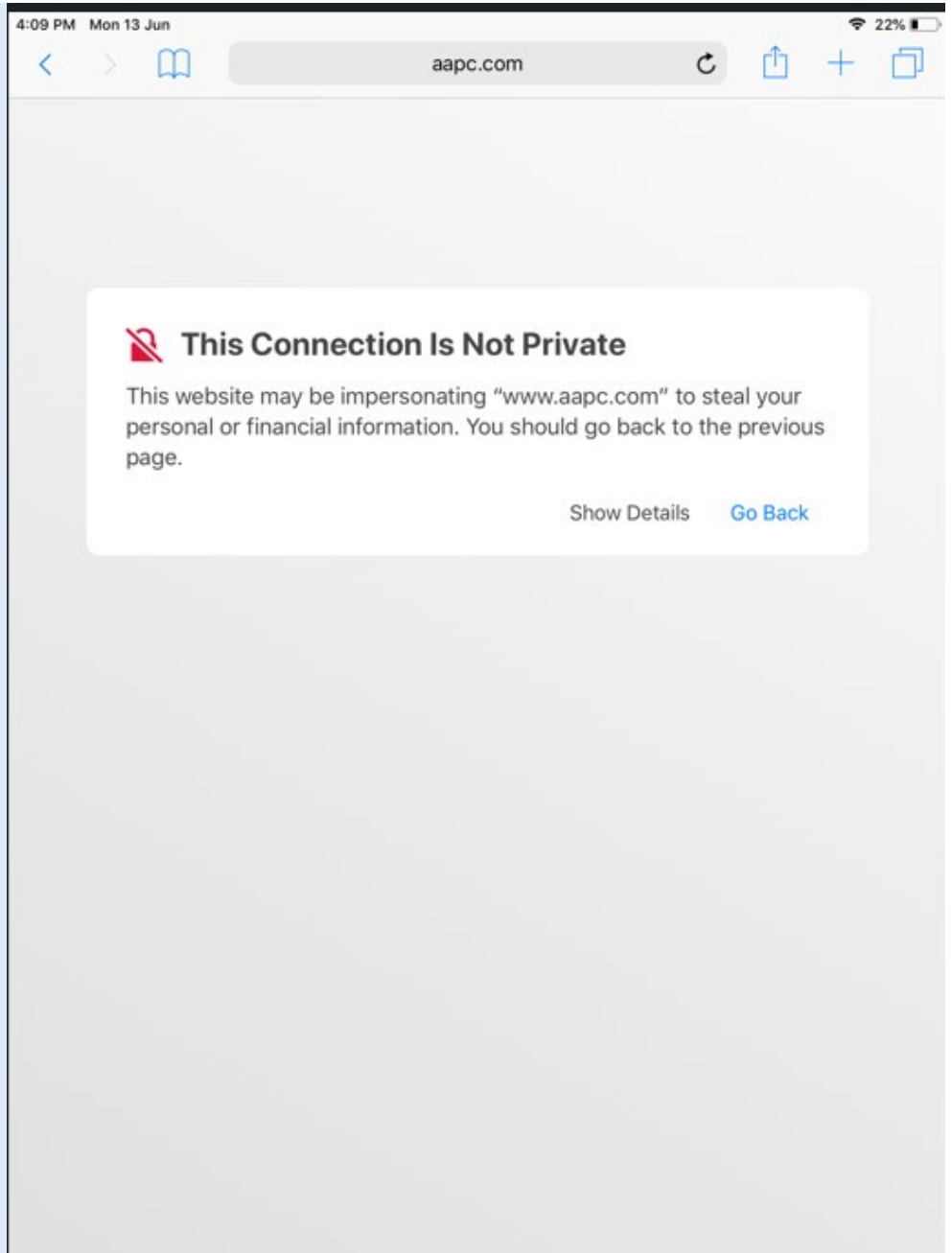

4. Click button visit this website to proceed

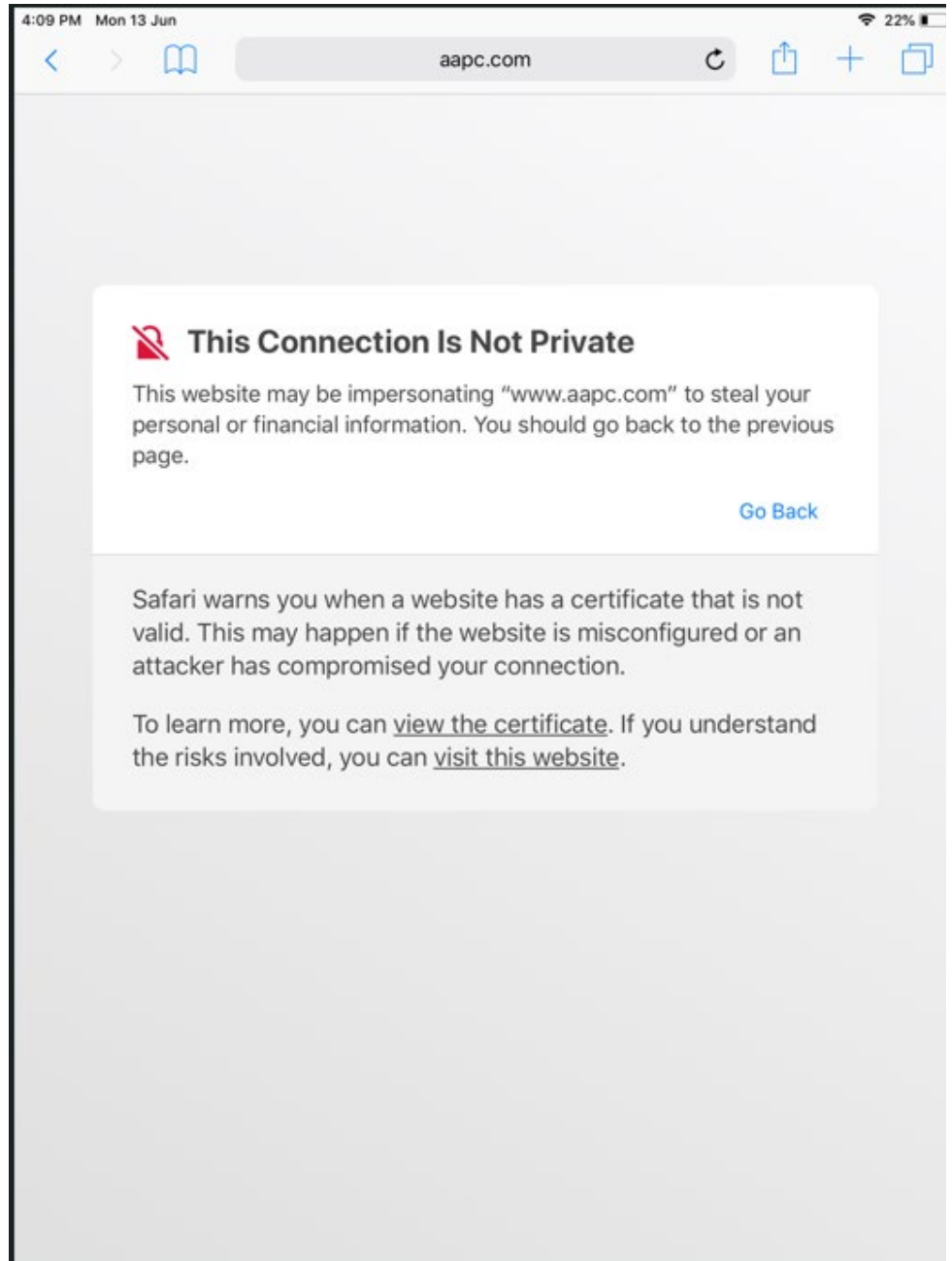

5. Click button Visit Website and it will pop up Login Page

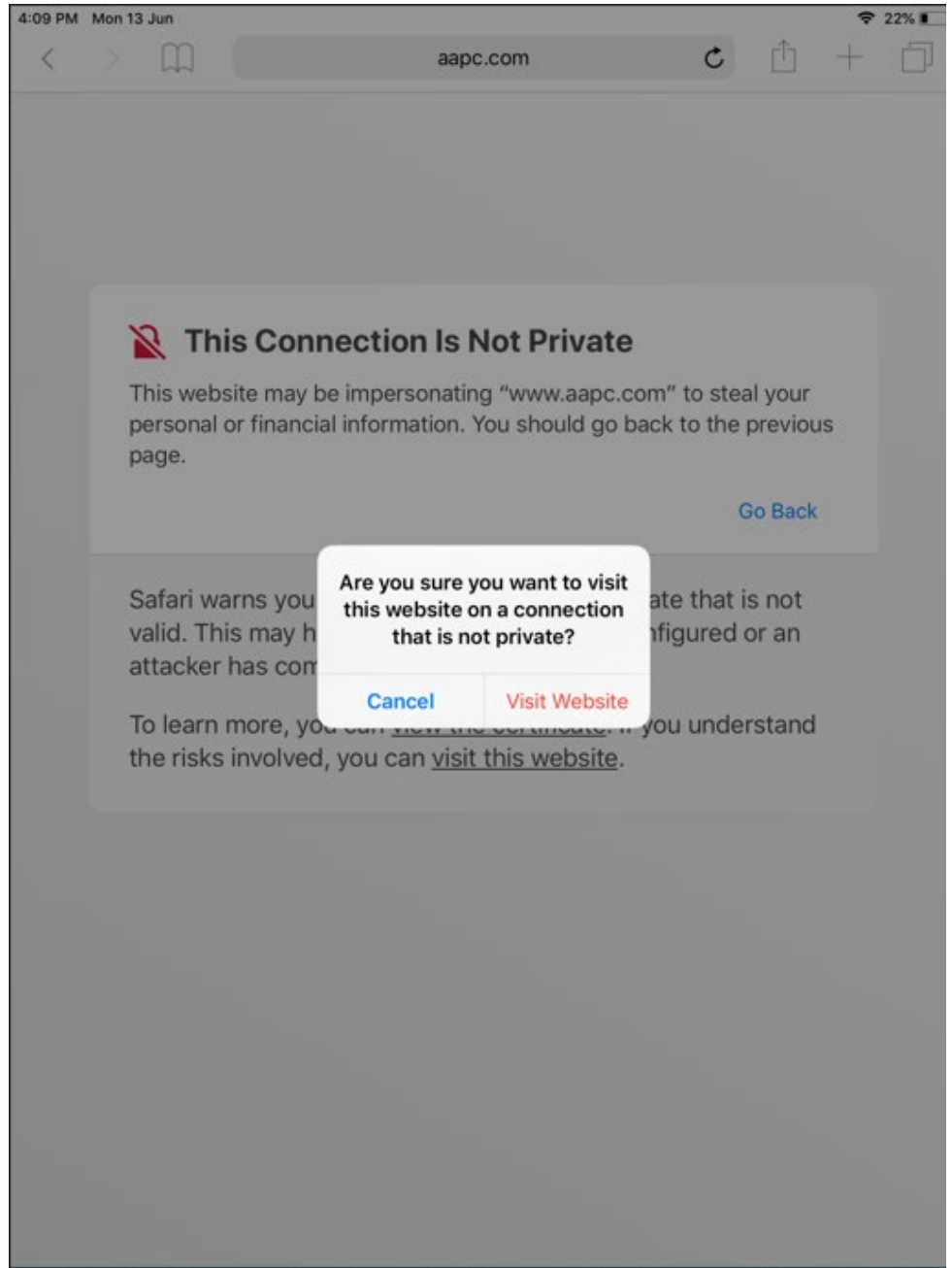

6. Login page will be directly appear, fill your iStaff/iStudent Username & Password Staff.

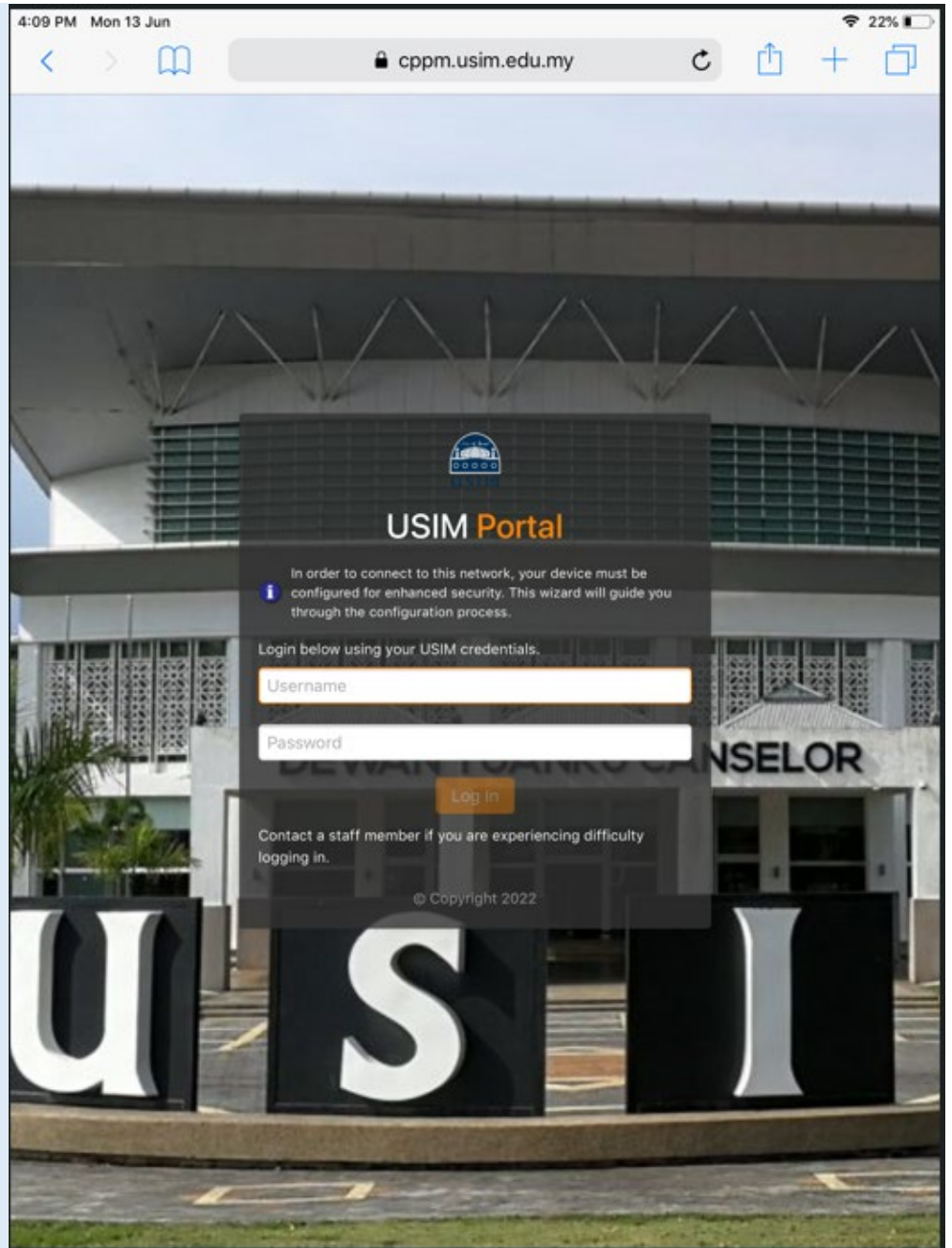



7. Setelah isi Username & Password, click button Log In

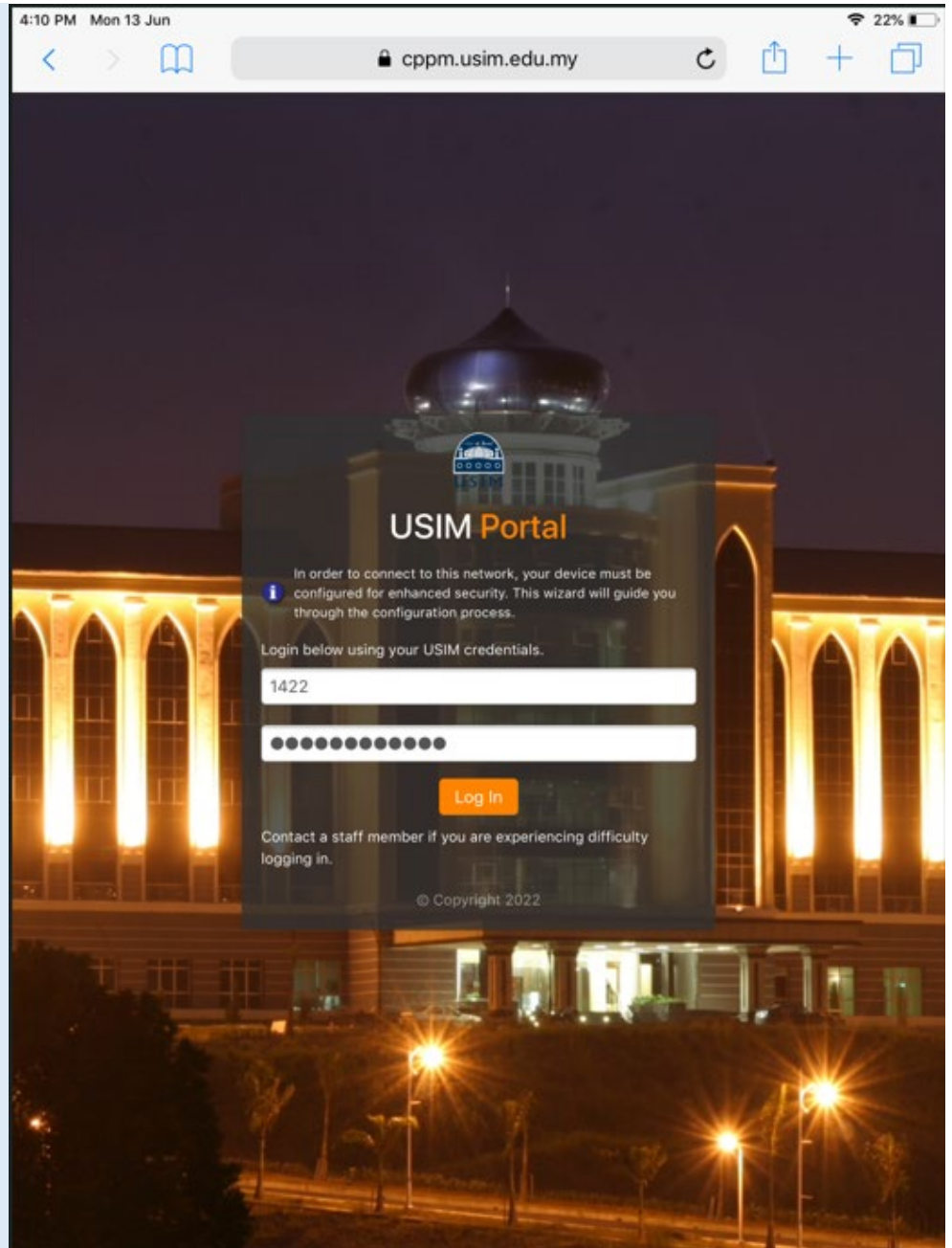



8. Click button Install Certificate

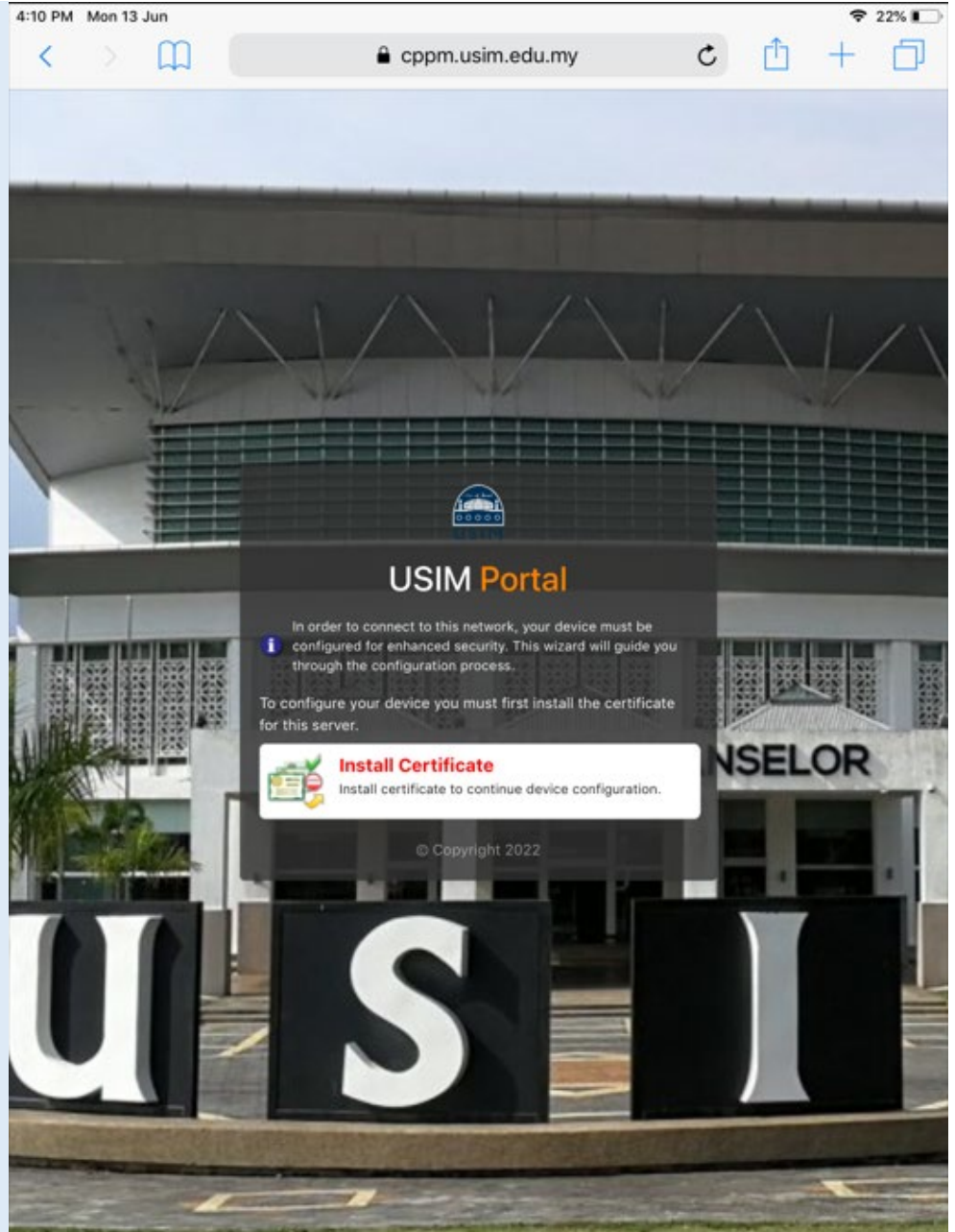

9. Click button allow to download and install certificate into iPad Device

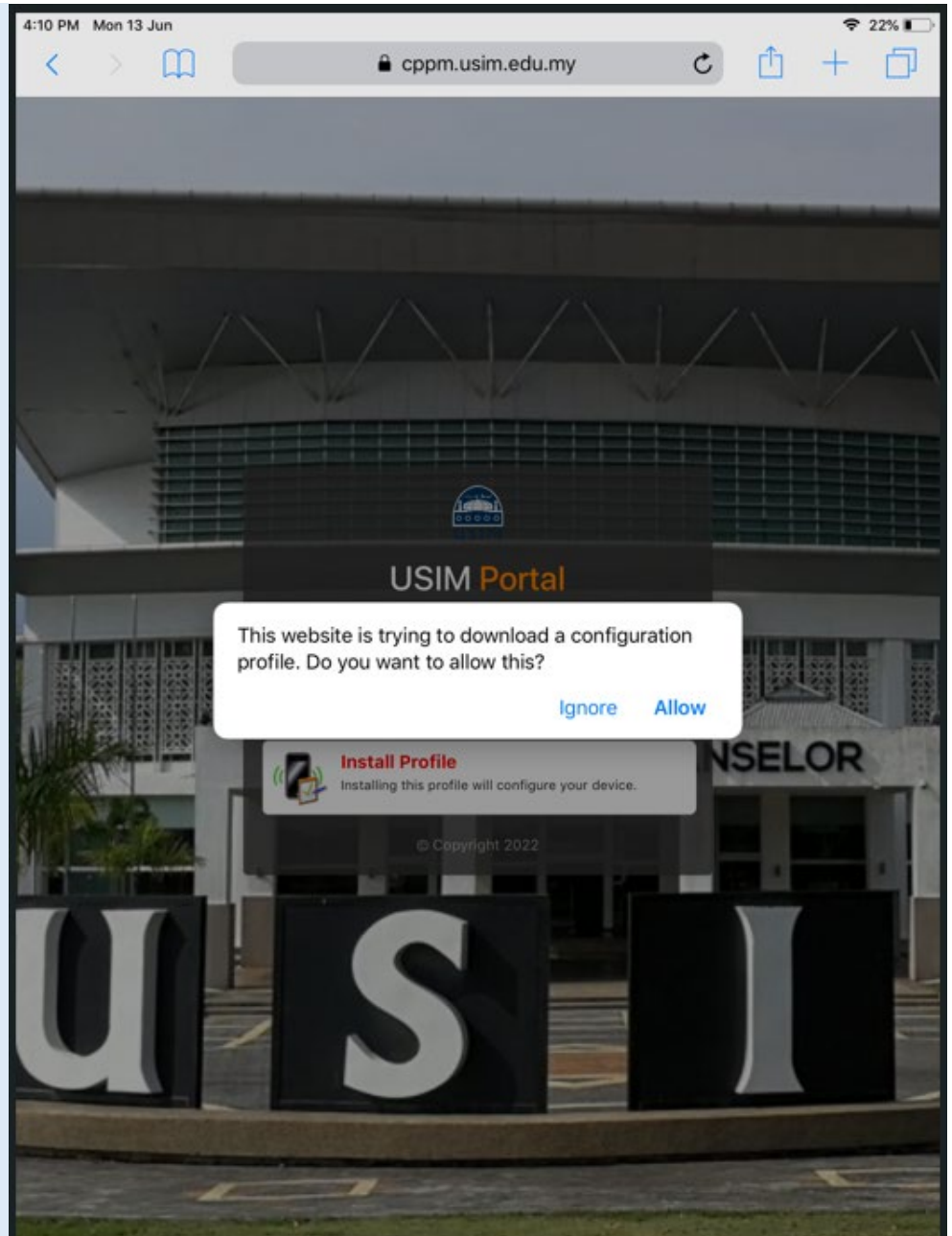

10. Certificate downloaded,  
Go to Settings app to install  
it

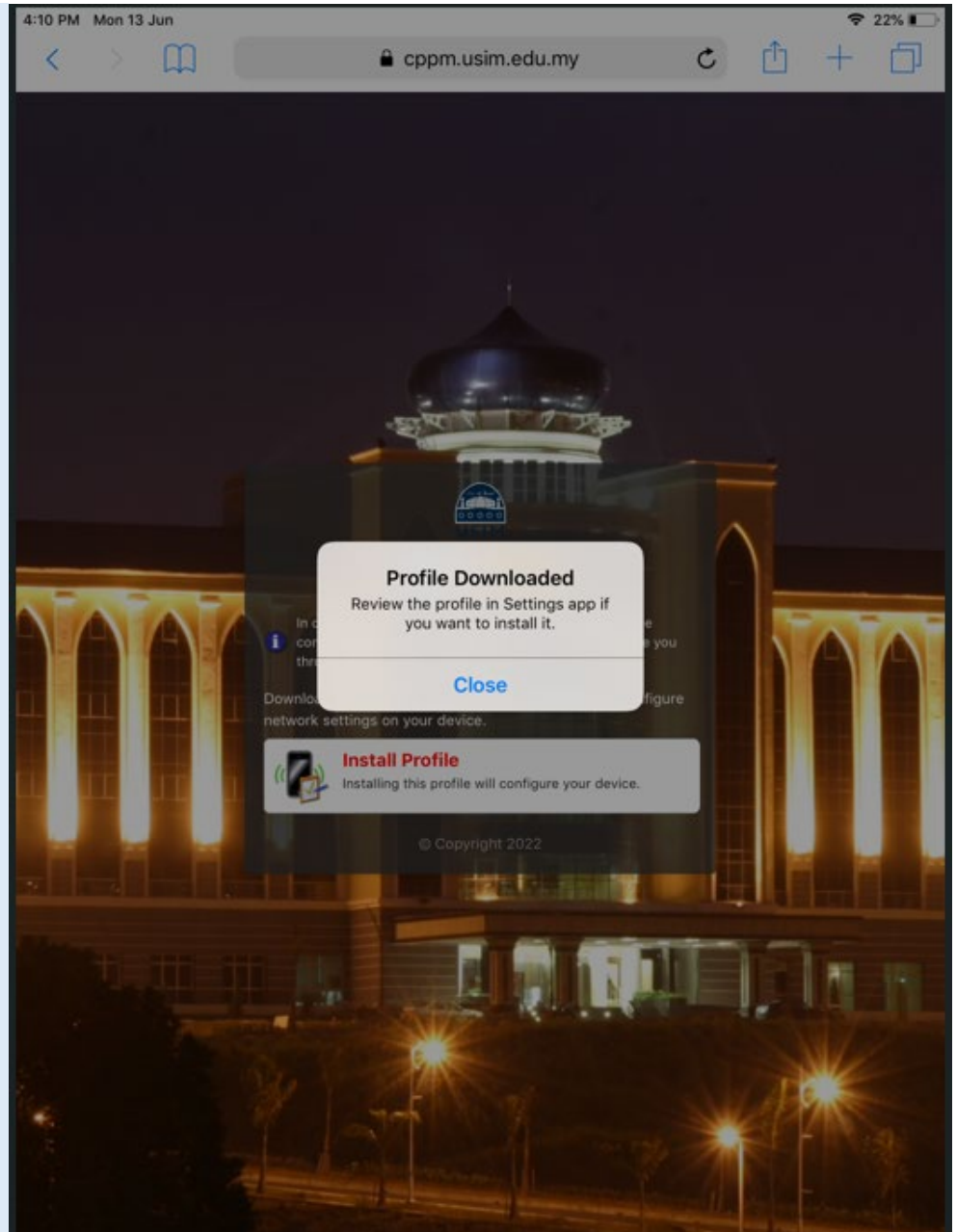

11. Navigate to Settings -> General -> Profile

Click downloaded profile

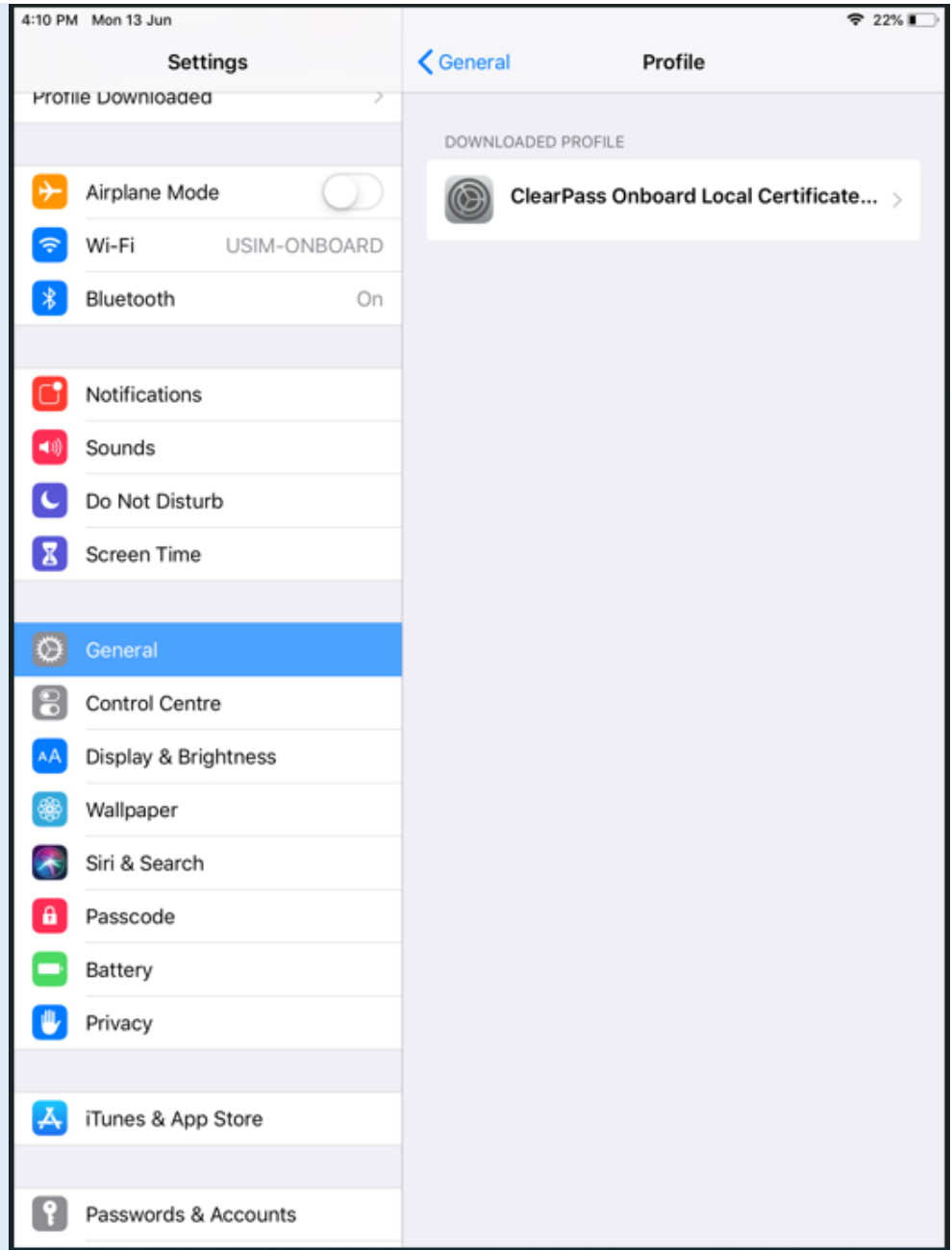

12. Enter password iPhone to proceed

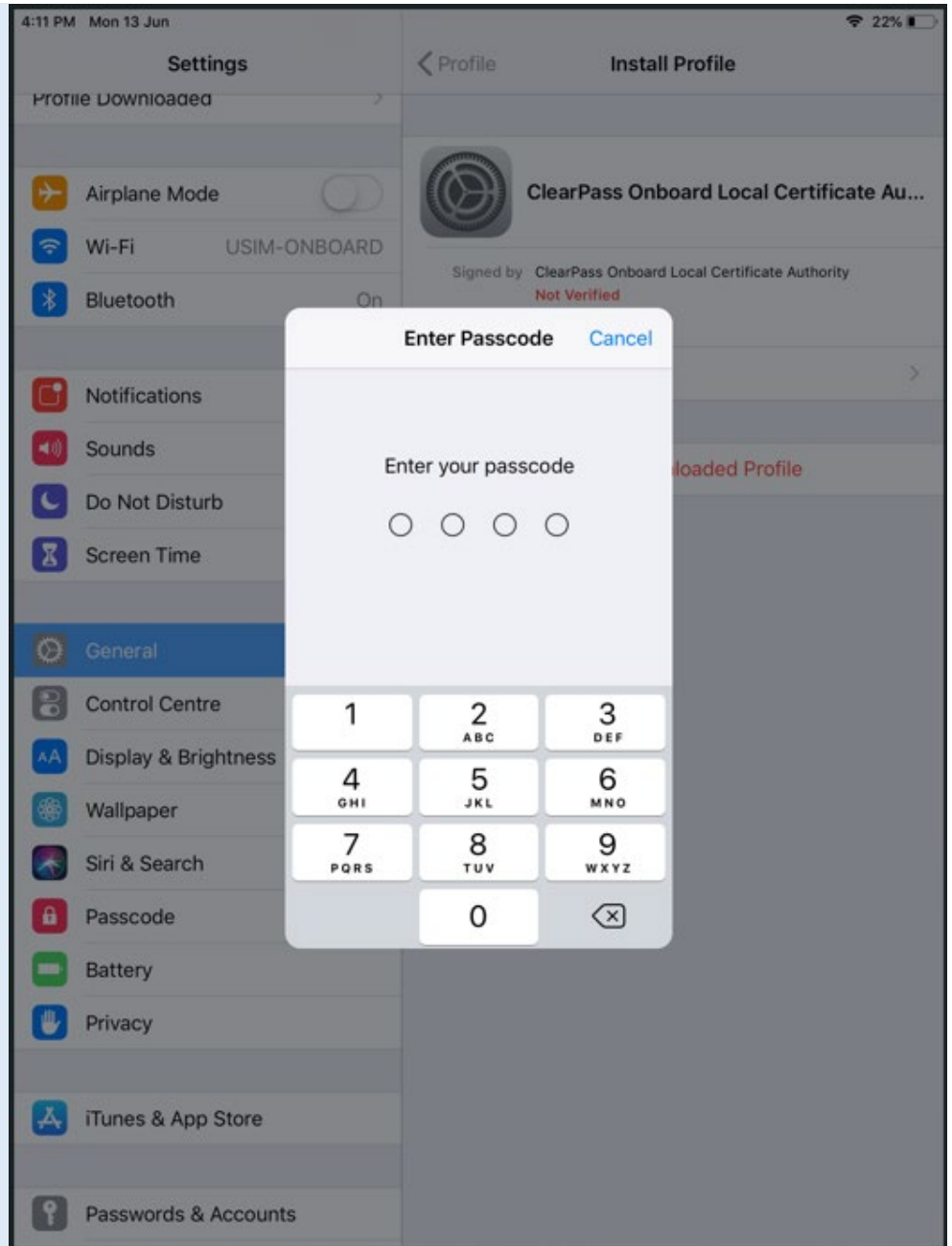

13. Click button Install to install certificate

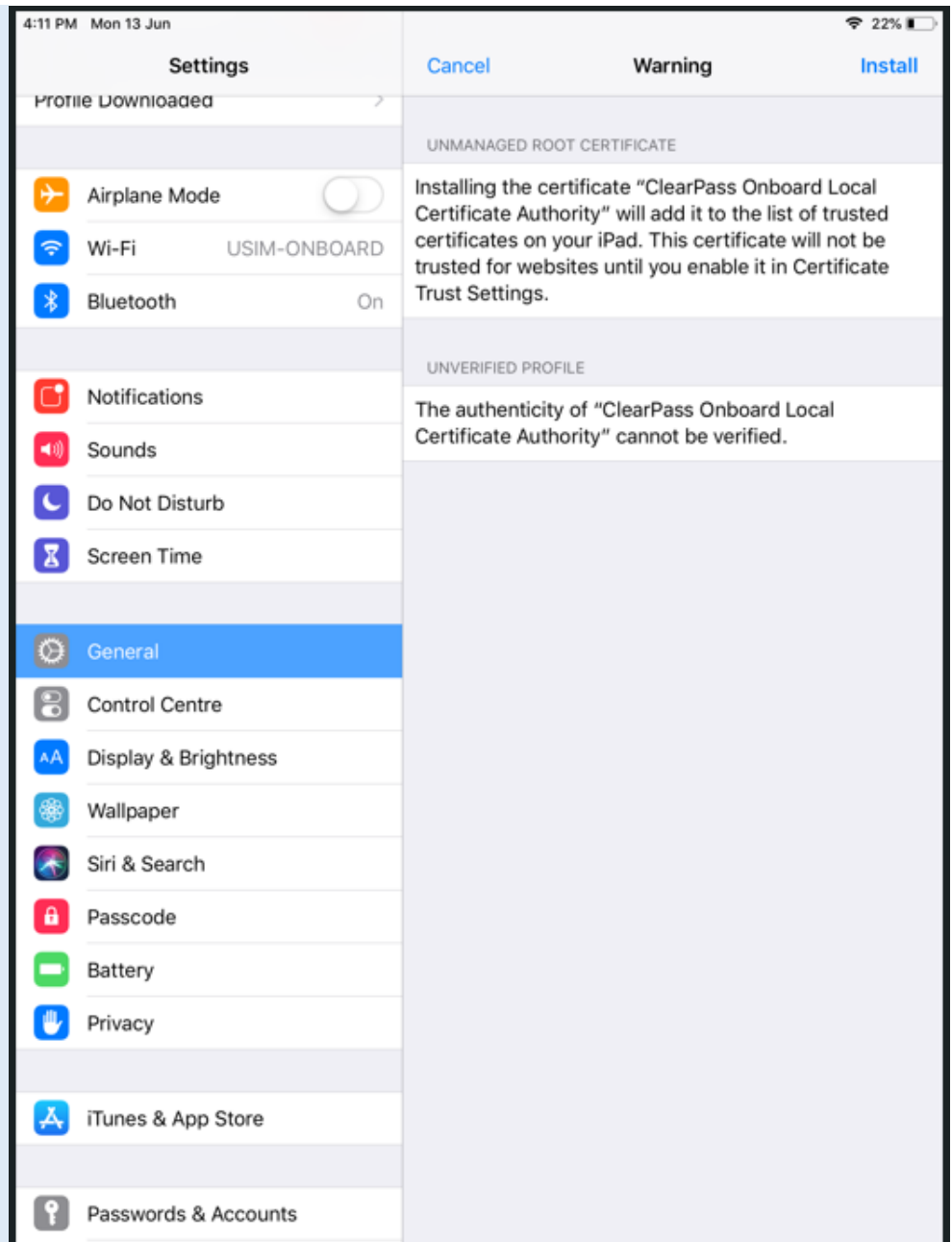

14. Click button Install to proceed with installation

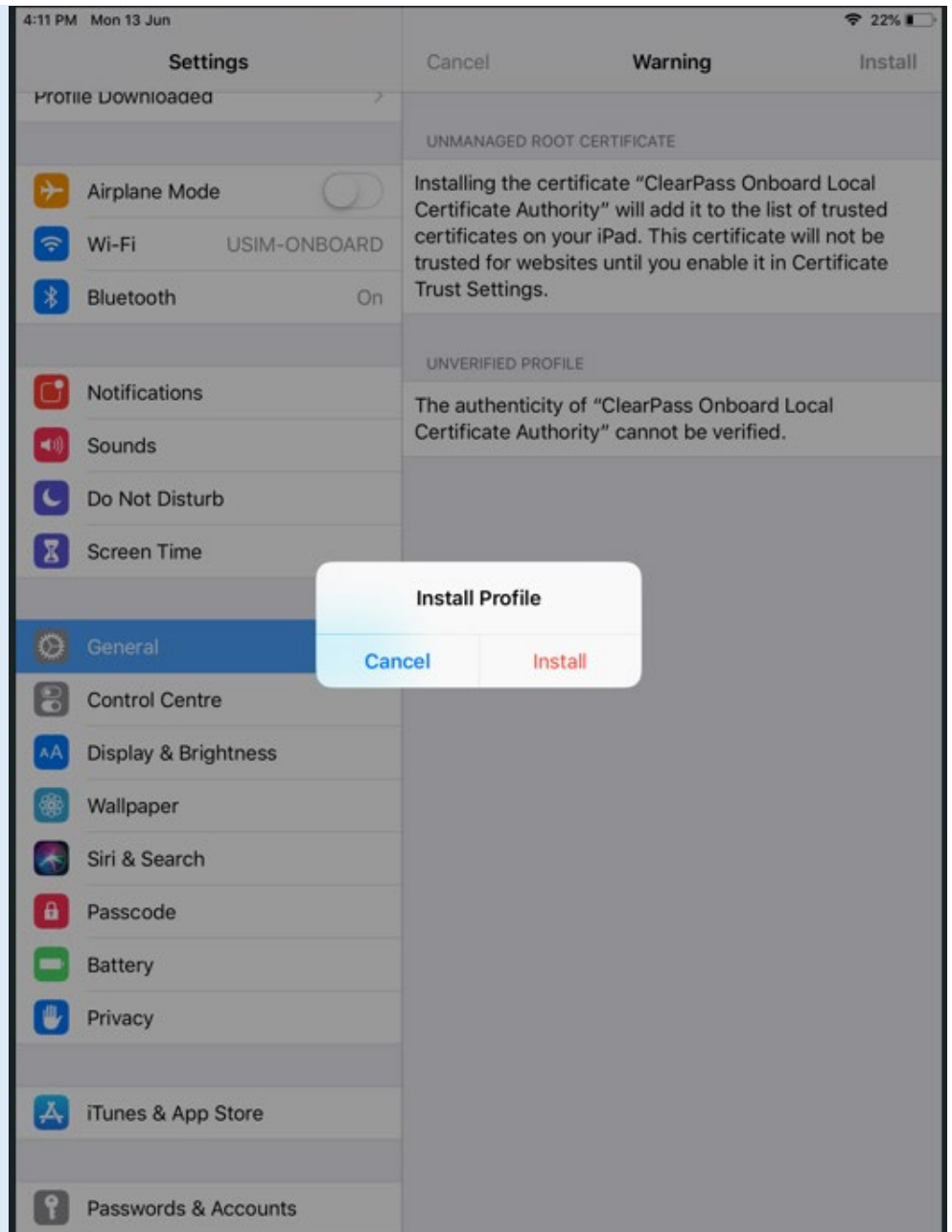



15. Certificate successfully install into profile iPhone

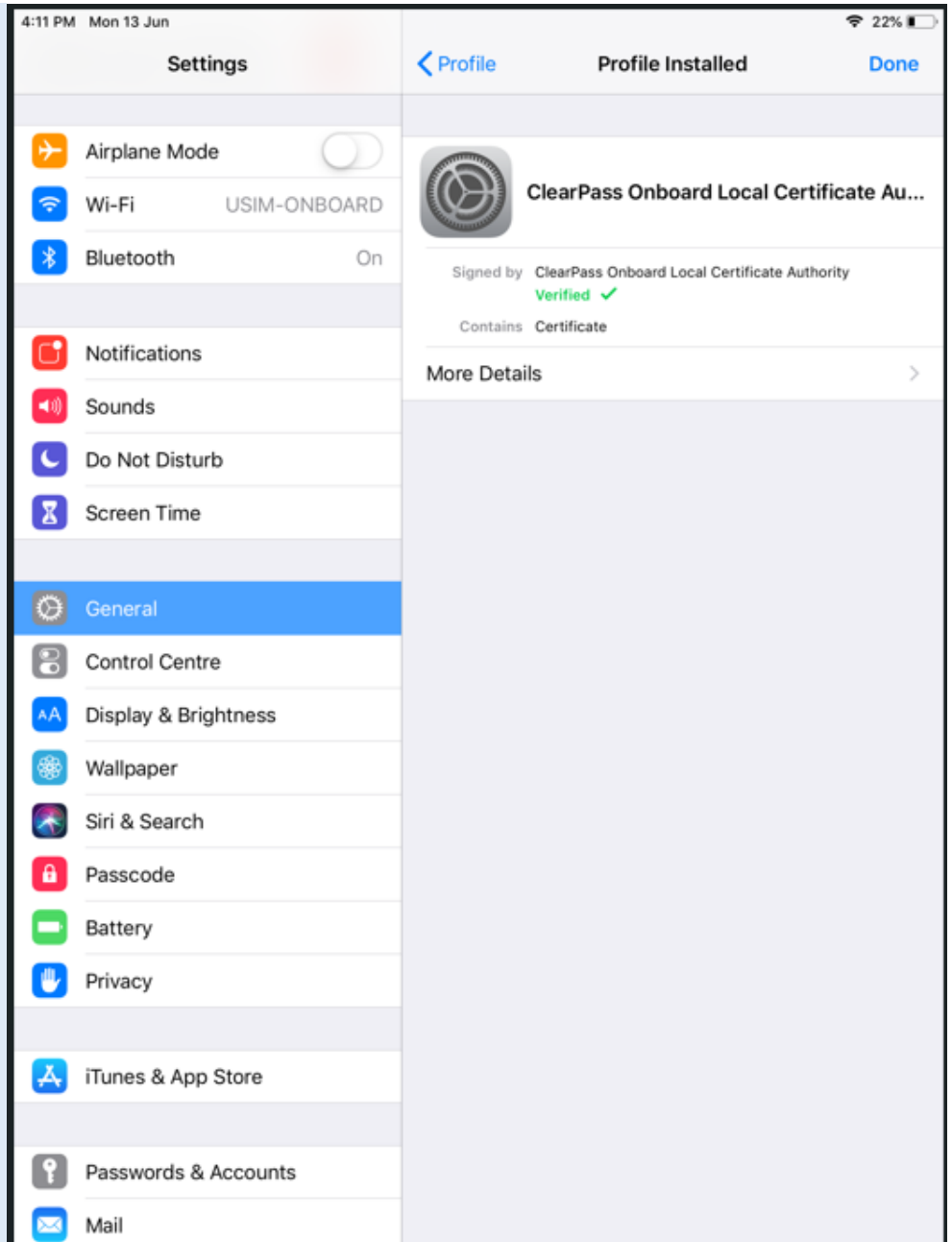

16. Click button Install Profile to download network profile

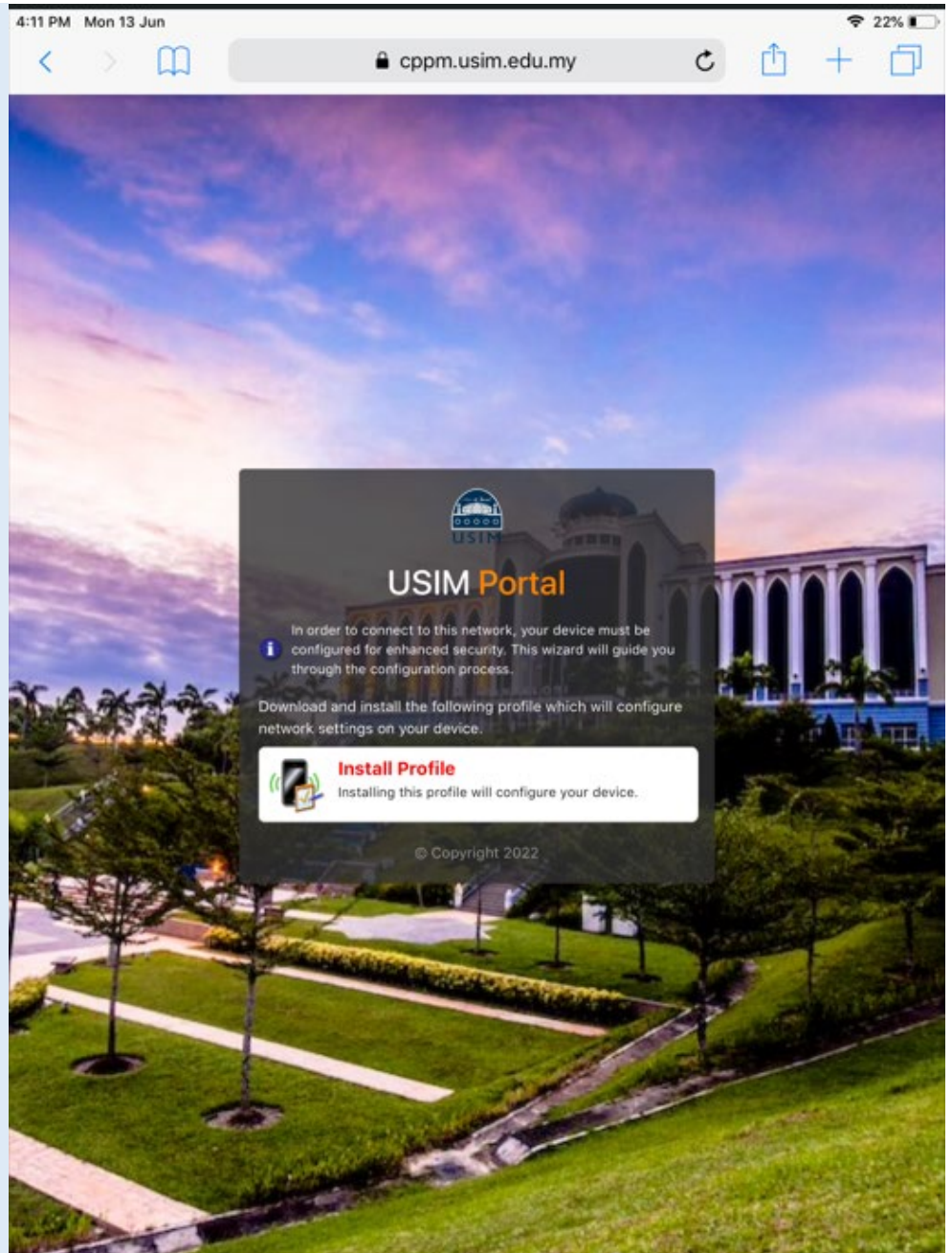

17. Click button allow to proceed

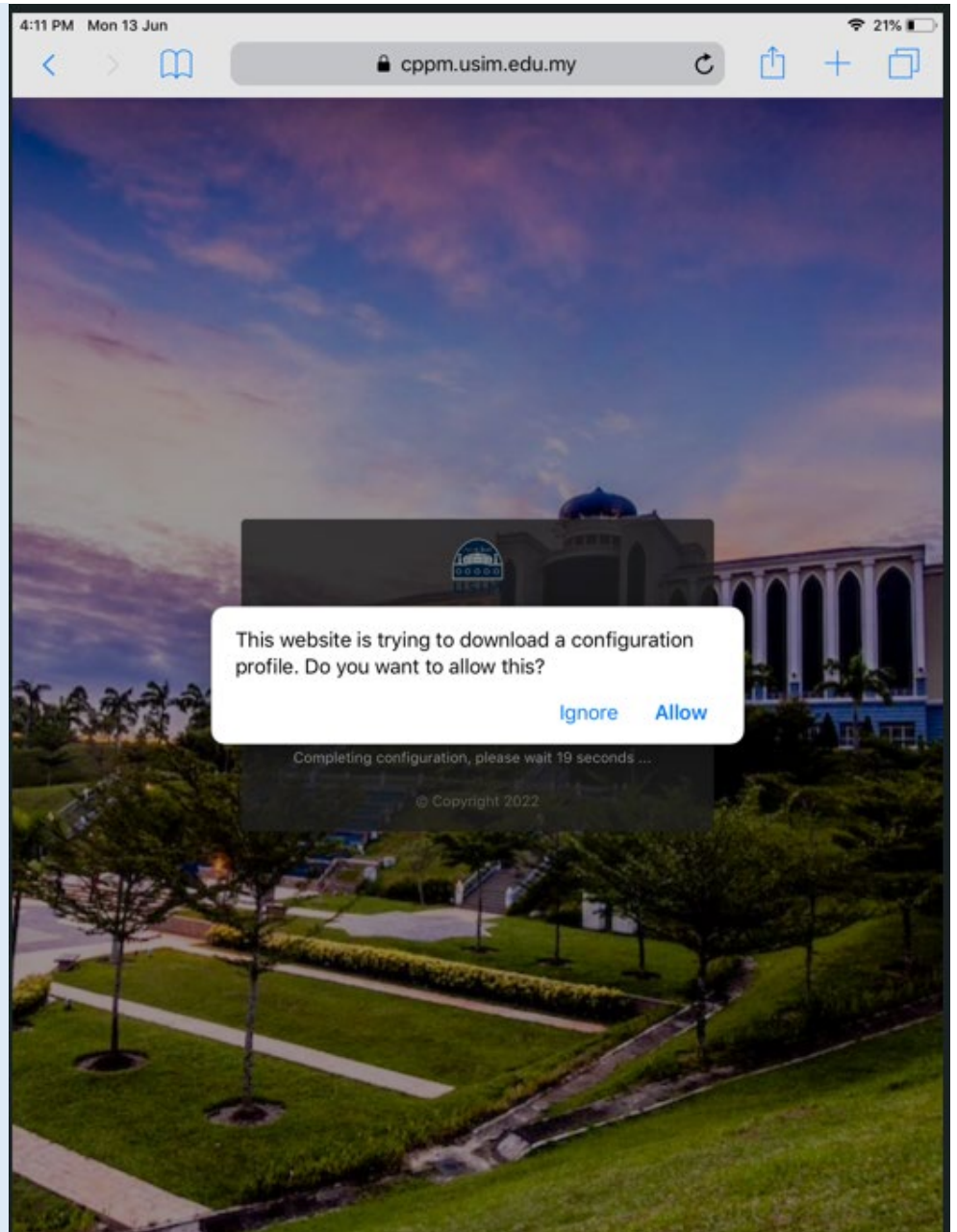

18. Network Profile downloaded, Go to Settings app to install it

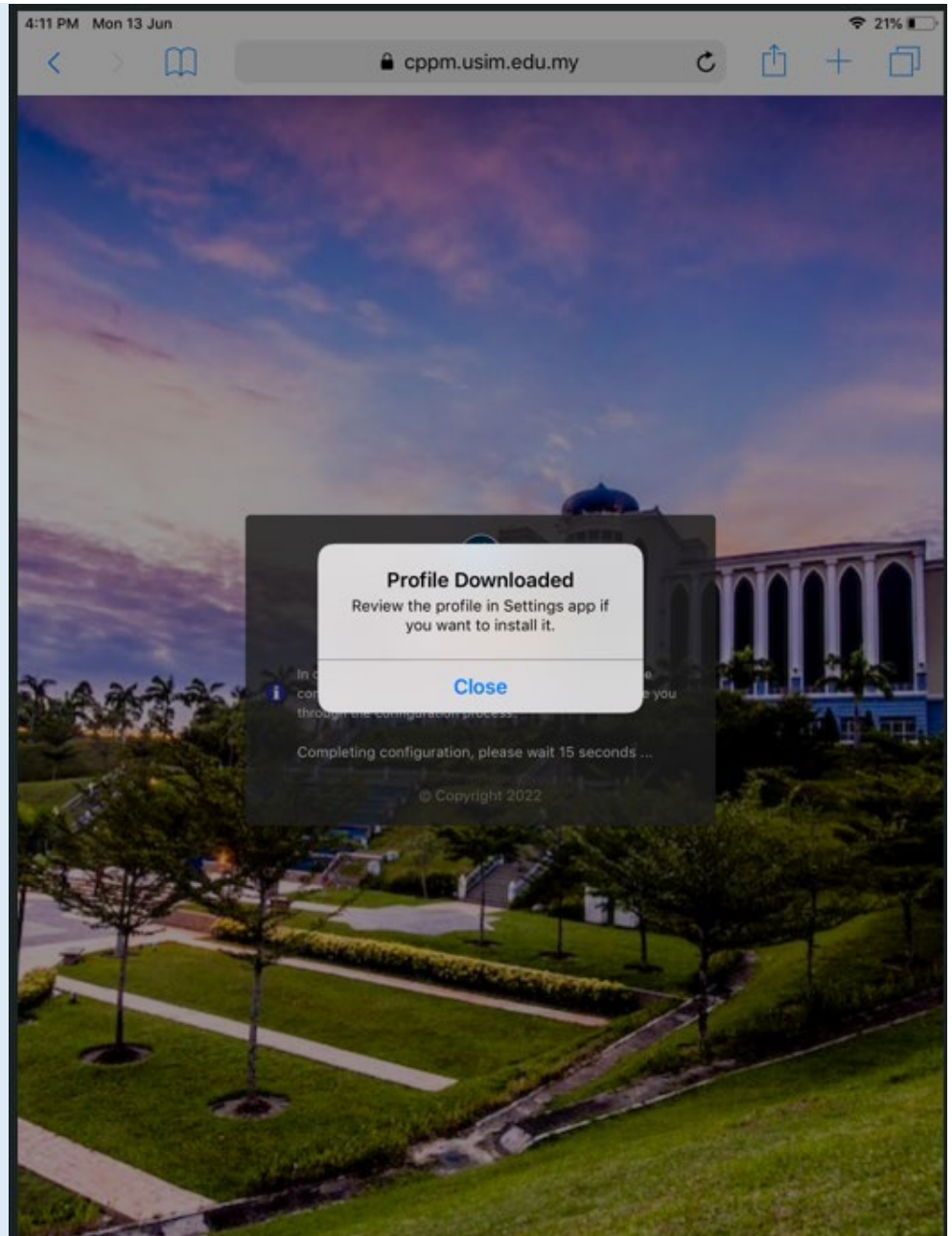



19. Please wait a while for configuration iPhone complete

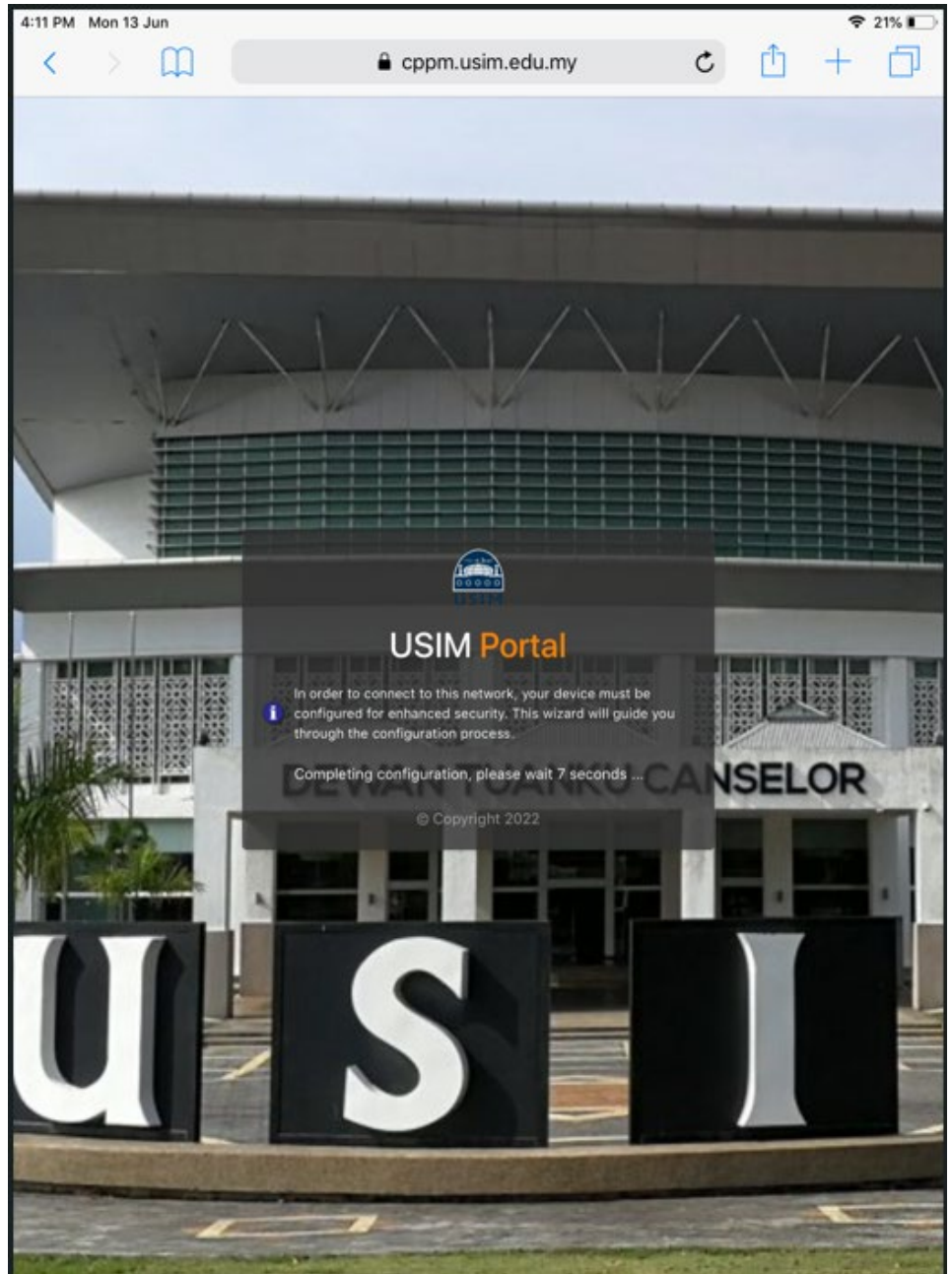

20. iPhone device provisioning complete. Navigate to Settings -> General -> Profile

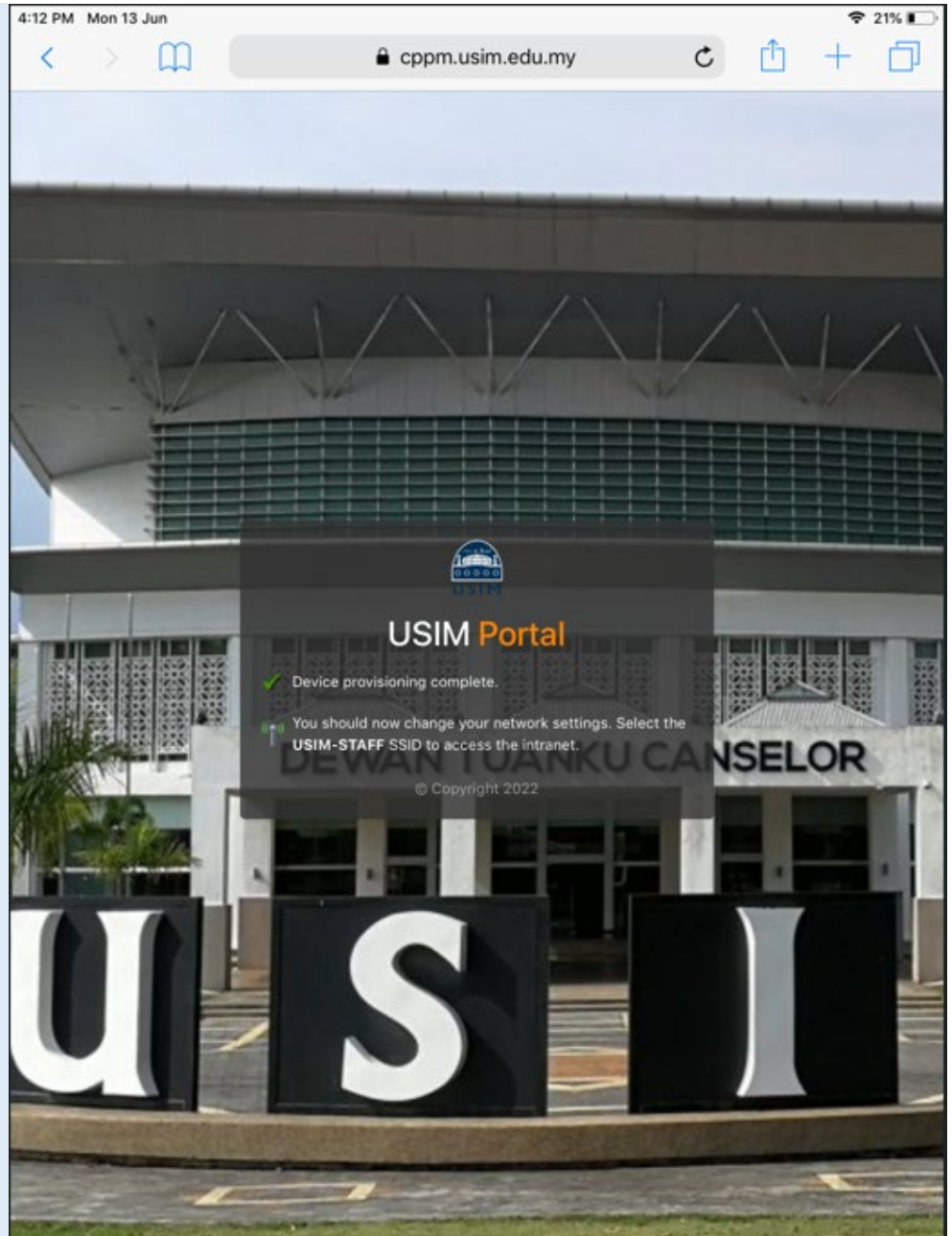

21. Click Device Enrollment to install Network Profile

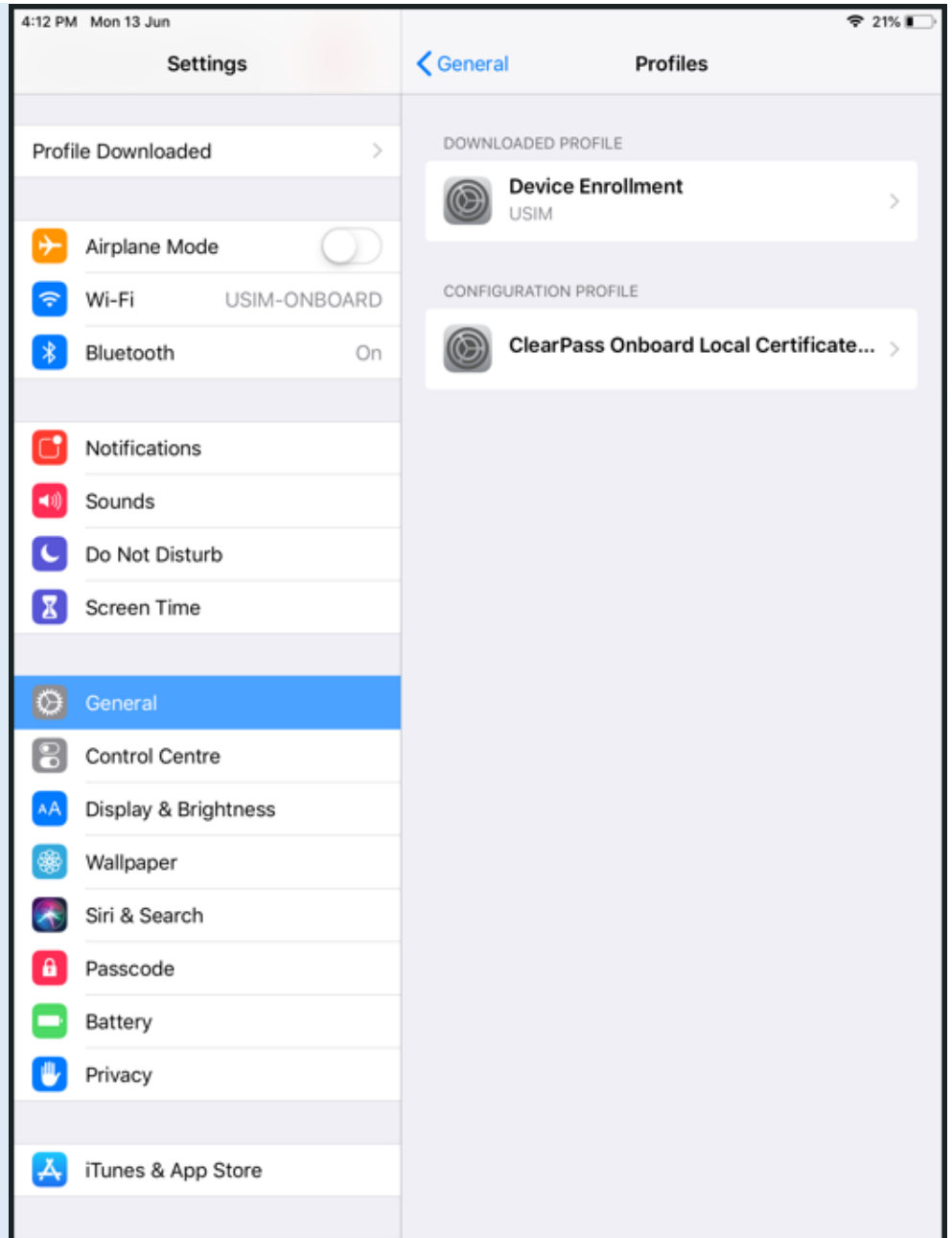



22. Click button Install to install Network Profile

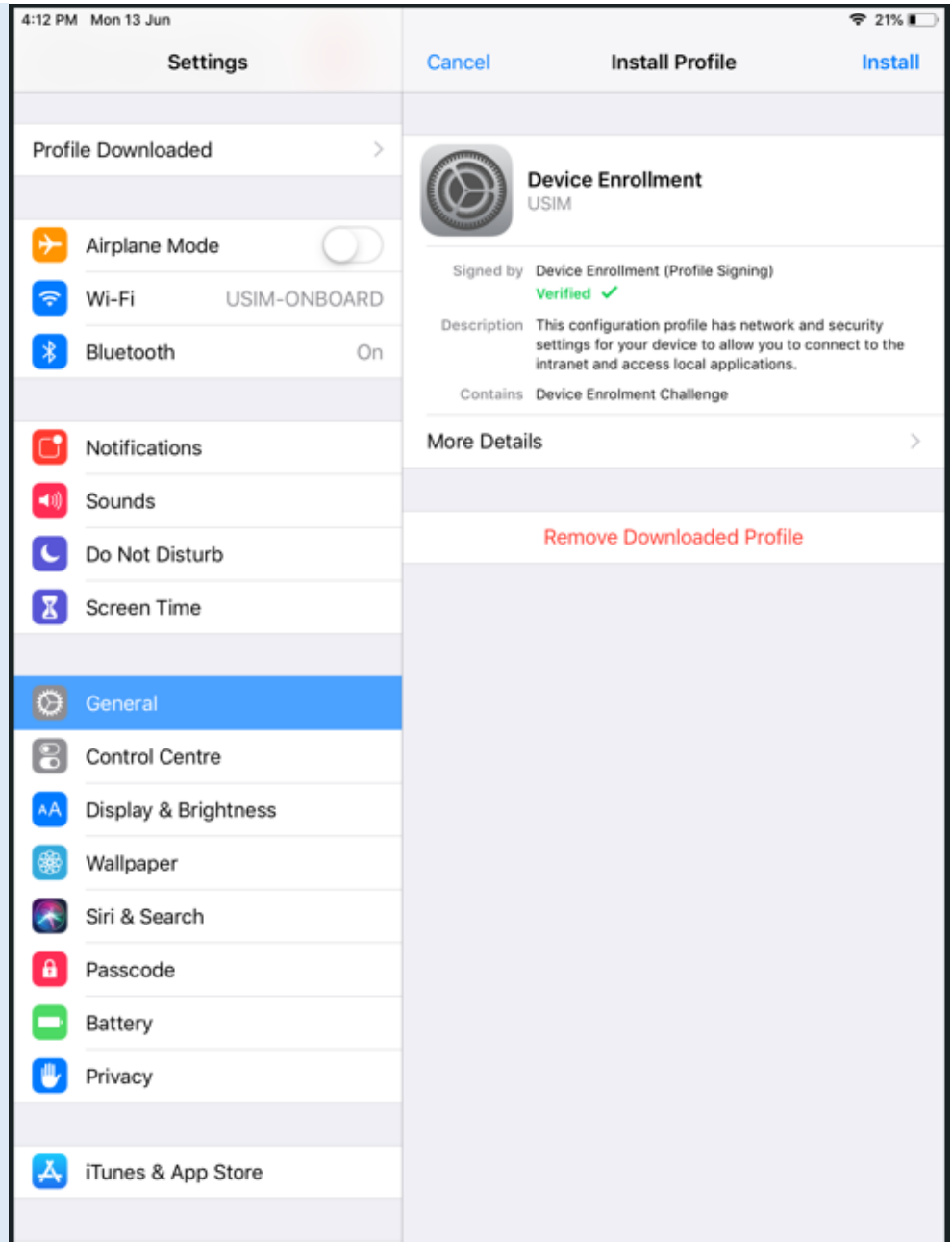

23. Click button Install to proceed

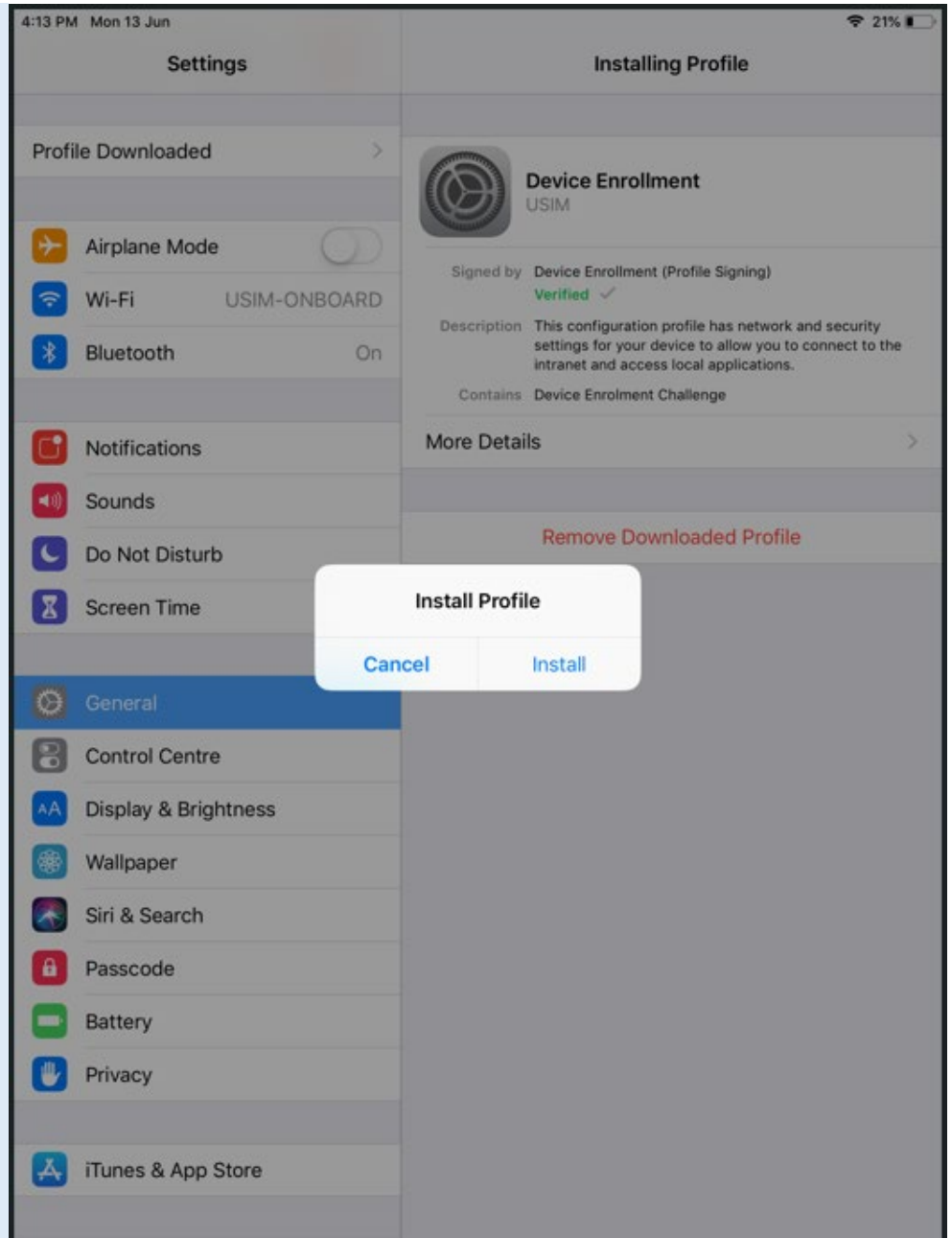

24. Click button Install to proceed with installation

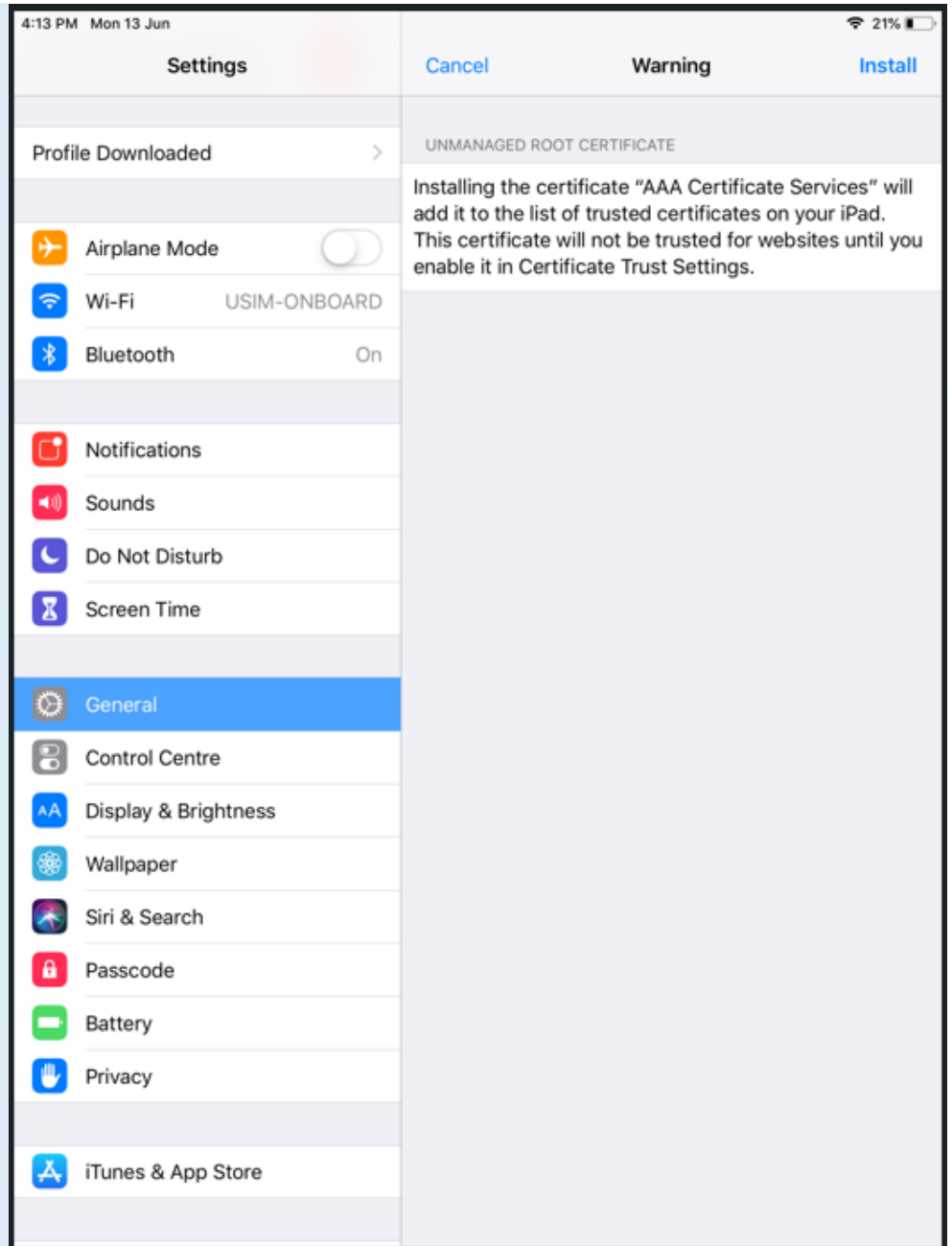

25. Click Install to proceed

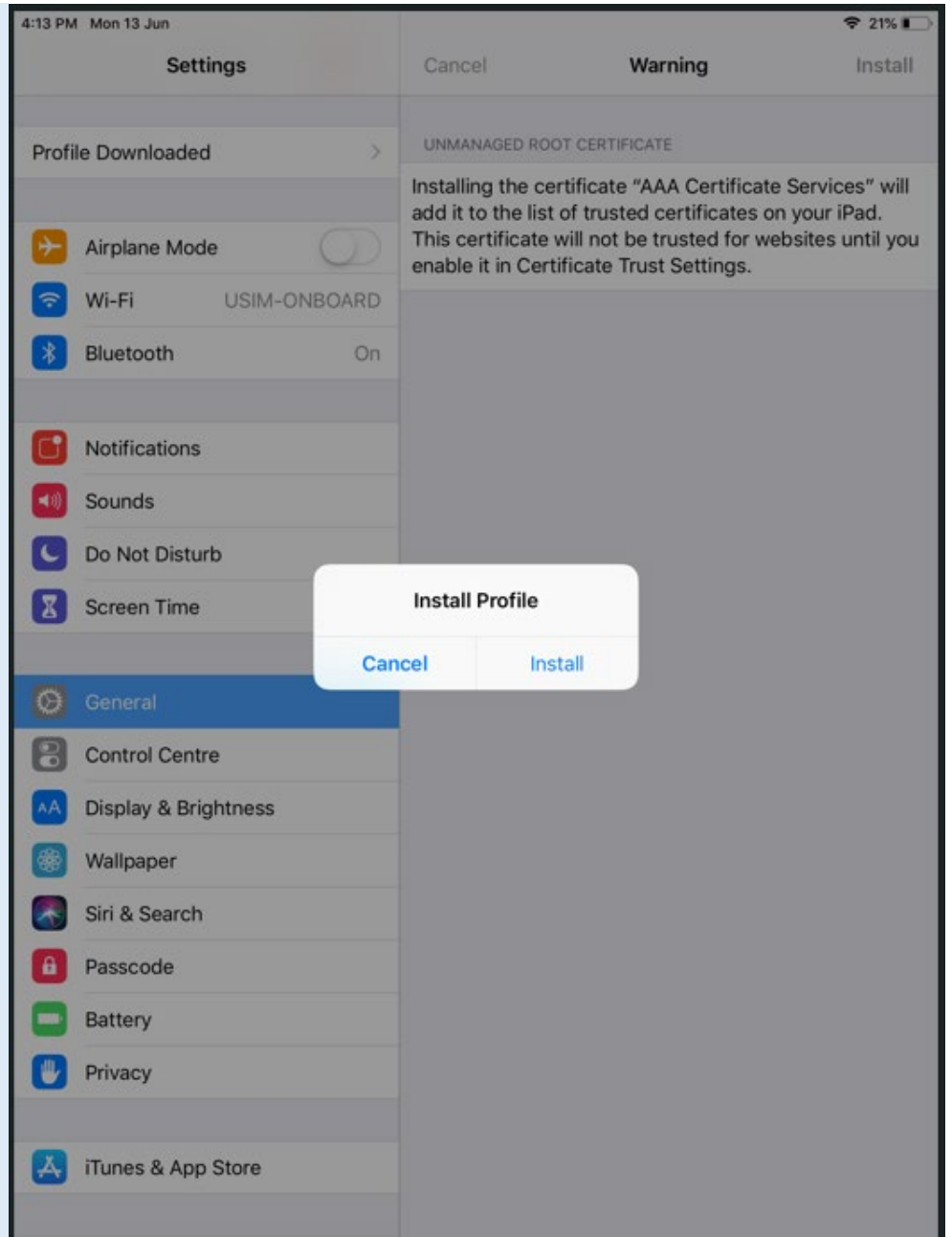

26. Network Profile successfully installed

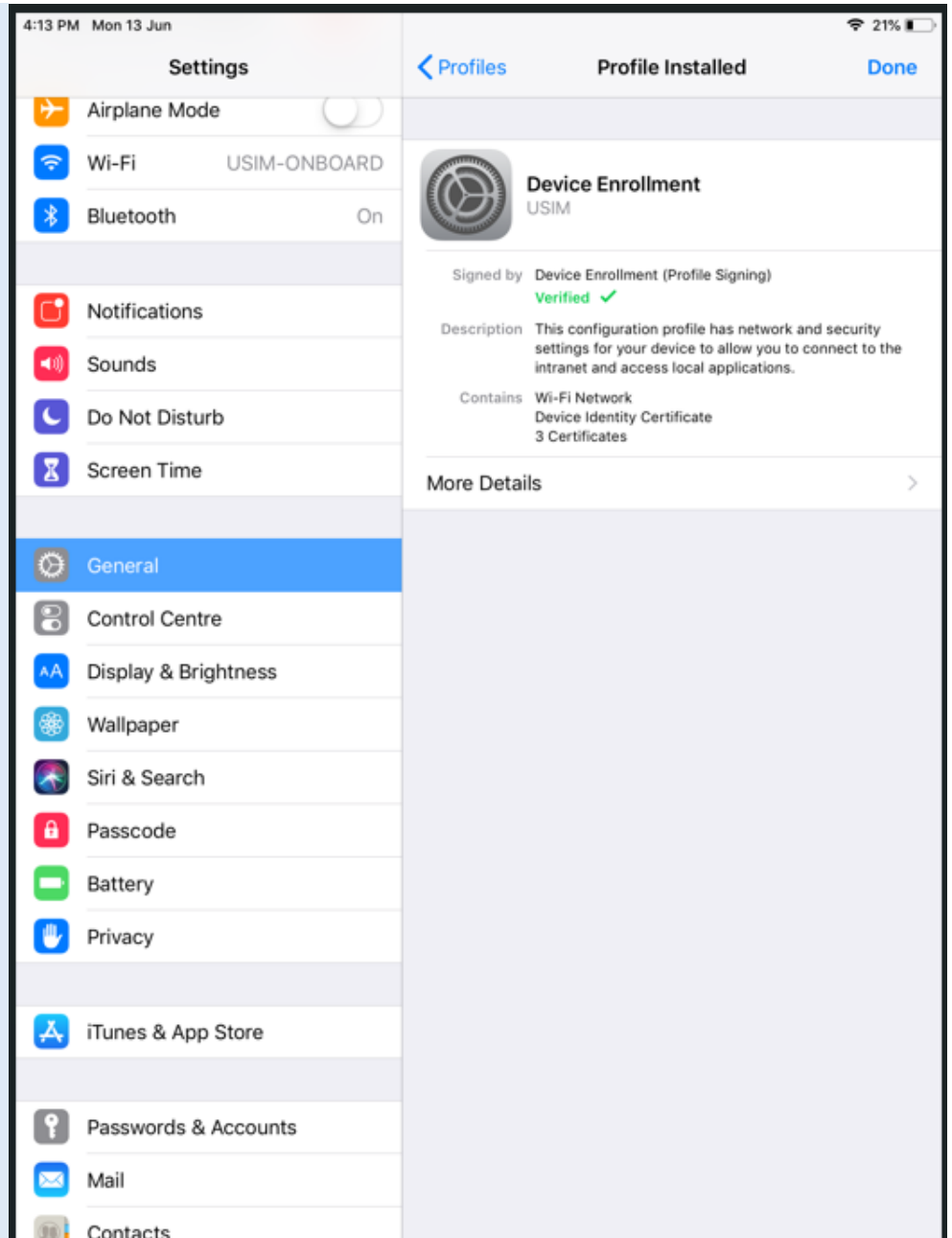

27. Navigate to WIFI Settings, manually click SSID name USIM-STAFF

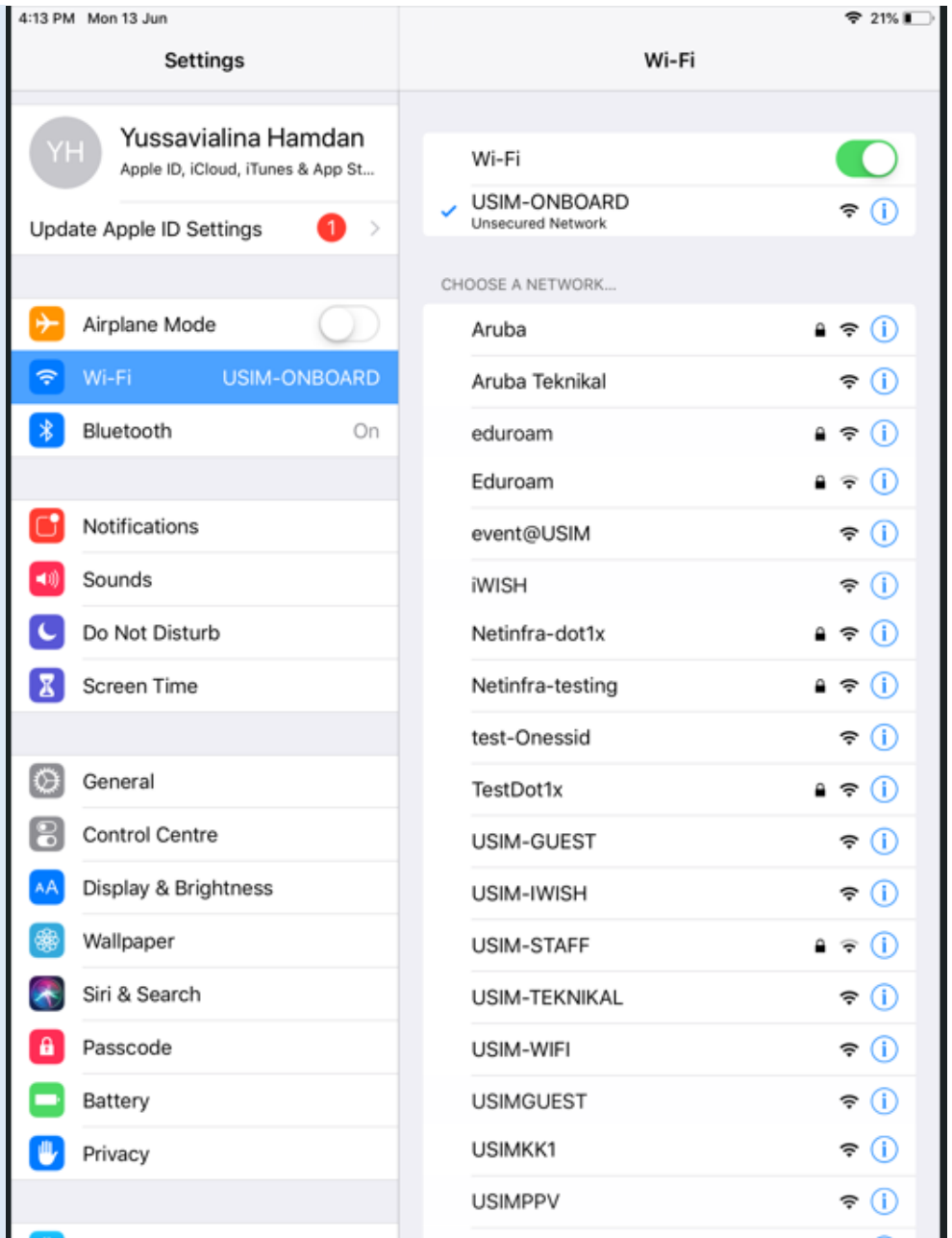

28. Successfully connected to SSID name USIM-STAFF and able access to internet

